



The venue

Winkworth Farm is a family owned and operated environmentally responsible wedding venue, set at the edge of the Cotswolds near the historic market town of Malmesbury.

The venue offers exclusive use for every wedding, so you can enjoy a private celebration with your guests. The beautifully renovated 17th-century Cotswold stone barn is nestled within the tranquil setting of 220 acres of organic pasture. The well-kept lawns, herbaceous borders and sunken garden sit within the beautiful organic meadows, providing stunning scenery and magical backdrops for your all important wedding photographs.



Your unique day

We (Jeremy, Melanie & Tom Newman) are with you from your initial enquiry all the way through until departure after the Big Day.

We pride ourselves on our flexibility for each and every booking and understand that no two weddings are the same, and why should they be! We encourage couples to have the unique day they would like and we do our utmost to accommodate your wishes in a friendly and professional manner.

Whether you are looking for a midweek wedding in the Winter, or whole weekend hire in the Summer, we aim to curate your perfect day just the way you would like it.



Ceremonies

Winkworth Farm is licensed to hold onsite ceremonies across four spaces:

- The Roundhouse & Sunken Garden - up to 148
- The Long Barn (inside) - up to 150
- The Main Threshing Barn (inside) - up to 200
- The Dutch Barn (outside, under cover) - up to 250

Post ceremony reception drinks are then served outside from the Courtyard Bar or inside by the bar. Music can be connected and played in each space (or live music if preferable).







Drink

Two package options available:

Winkworth Farm Package - £22.95 pp

Reception drink + top-up (i.e. Prosecco, Cocktails, Bottled beers), half a bottle of wine per person for the meal, and a glass of Prosecco for toasts.

Bring Your Own Package - £12.95 pp

Bring your own drinks to cover post-ceremony/reception, wine for the meal (replenished throughout) and toasts. Storage, chilling and glassware included.

The Winkworth Farm bar is open throughout the whole day from an hour prior to onsite ceremonies until last orders at 11:30pm.







Eat

Winkworth Farm have three excellent caterers to choose from who will provide your daytime and evening food. Each caterer includes staff, cutlery, crockery and will lay your tables with favours and decorations on the morning of the wedding. They are also available to provide catering the following day if choosing to hold Brunch at the venue. Please contact them direct for up-to-date pricing, menus, queries and to book tastings!

Warings Catering - info@waringscatering.co.uk / 01666 824 379

Wild Fork - info@wildforkwest.co.uk / 01380 870 398

Relish - info@relishmail.co.uk / 01285 658 444

Popular options include post ceremony canapés, wedding breakfast and evening food.











Stay

The Courtyard Barn - £250

Includes Champagne Breakfast Hamper

Access from 11am on the day to get ready for onsite ceremonies.



Holiday Lets

Winkworth Grove - 4 rooms, sleeps 8 (2 nights min.)

Winkworth Farmhouse - 3 rooms, sleeps 7 (2 nights min.)

Please note Holiday Let bookings are first come, first served and subject to availability. Please contact our office for up-to-date pricing.

The Courtyard Barn (sleeps 2, where the wedding couple stay on the night of the wedding) is always available on the night of the wedding (if required) and isn't let to other parties if not taken.



Winkworth Grove











Winkworth Farmhouse











Onsite Glamping

Supplied via

David Winterflood, Great British Glamping

www.greatbritishglamping.com

07919 021 912

Furnished, luxury onsite Glamping bell tents can be arranged through GBG - available April - October. A great addition to our Brunch offering in the venue the following day.

Winkworth Farm provides designated flushing toilets and hand wash basins for overnight Glamping guests. David / GBG is also able to source shower units for an additional cost if desired.





Waggoner
Glamping
Loos
This Way
↑



NO SMOKING

PRIVATE





1 Main Entrance
2 Main Threshing Barn
3 Long Barn
4 Woodbridge Room
5 Toilets
6 Folly

7 Kitchen / Caterers Access
8 Courtyard Barn
9 Roundhouse / Sunken Garden
10 Courtyard Bar
11 Farmhouse Lawn
12 Winkworth Farmhouse

13 Car Park (80 vehicles)
14 Coach Park (3 coaches)
15 Winkworth Grove
16 Staff Parking
17 Dutch Barn
19 Glamping Toilets
20 Glamping Field



Winkworth Farm

Lea, Malmesbury
Wiltshire SN16 9NH

01666 823499
info@winkworthfarm.com
www.winkworthfarm.com



- 1 Commercial Kitchen
- 2 Main Threshing Barn/Dining Area
- 3 The Folly
- 4 Cloakrooms/WC
- 5 Civil Ceremony Room & or Dance Area
- 6 Bar Area
- 7 Courtyard with Seating
- 8 Main Entrance

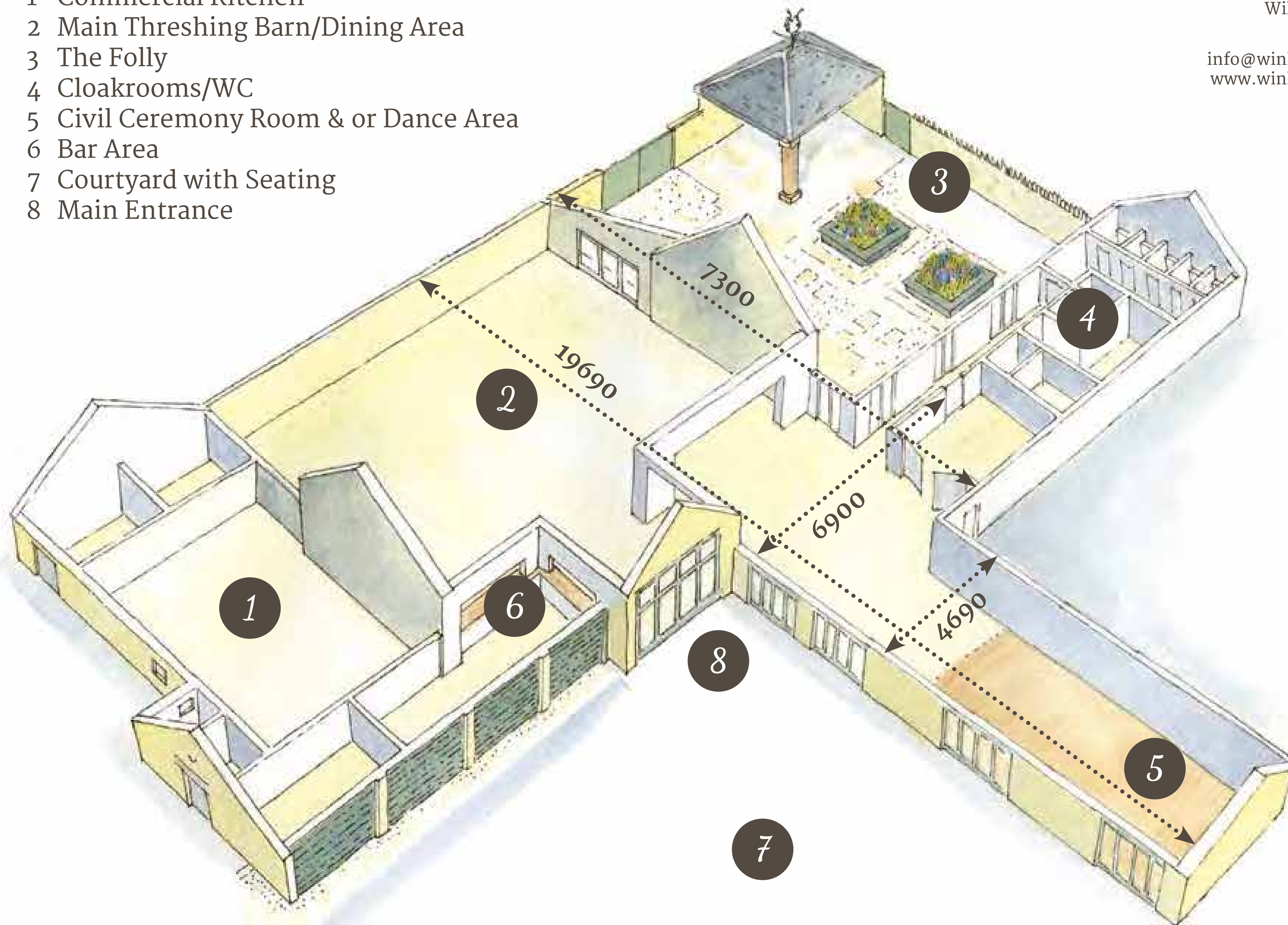







Nearby Accommodation

The Old Bell, Malmesbury - 35 rooms, 10 mins

The Kings Arms, Malmesbury - 20 rooms, 10 mins

The Horse & Groom Inn, Charlton - 5 rooms, 5 mins

The Rectory, Crudwell - 18 rooms, 15 mins

The DoubleTree by Hilton, Swindon - 171 rooms, 25 mins

DeVere Cotswold Water Park, South Cerney - 328 rooms, 25 mins

There are also large and small local properties available to hire via Airbnb & Sykes Cottages within a short distance of the venue.



Suppliers

Wedding Stationery | Angela Farley, Lovestruck Stationery | www.lovestruckstationery.co.uk

Prop Hire & Vintage Horse Trailer | Tom Newman, Winkworth Hire | www.winkworthhire.com

Glamping | David Winterflood, Great British Glamping | www.greatbritishglamping.com

Cakes | Hannah Culley | www.hannahculleycakes.com

Flowers | Jo Poole, Scentiments | www.tetburyflorists.co.uk

Photographer | Lucie Hamilton | www.luciehamiltonphotography.co.uk

Disco | Kenny Welch, Elite Promotions Disco | www.weddingdj.dance

Band | The Shadow Monkeys | www.theshadowmonkeys.co.uk

Music Agency | Après Ski Bands | www.apresskibands.com

Videographer | Darren Jack | www.darrenjackweddingfilms.com

Magician | Darren Campbell | www.darrencampbellmagic.co.uk

Make-Up Artist | Holly Anderson | www.hollyandersonmakeup.co.uk

Please contact our office if you require further assistance and recommendations with regards to suppliers.



Transport

Coaches, minibuses and private vehicle hire can be arranged via the following:

Andrew James, Malmesbury - sales@andrew-james.co.uk / 01666 825 655

Barnes Coaches, Swindon - coachhire@barnescoaches.co.uk / 01793 821 303

AD Rains, Brinkworth - enquiries@adrainscoaches.co.uk / 01666 510 874

Ellisons, Cirencester - sales@ellisonscoaches.co.uk / 01285 861 224

Please contact us for up-to-date local taxi options (best to pre-book).



Pricing & Packages

Please see the enclosed venue hire and extras pricing card.

Up-to-date pricing and packages can also be viewed at:

www.winkworthfarm.com/prices

For quotes and availability with regards to the onsite Holiday Lets (Winkworth Grove & Winkworth Farmhouse), please contact our office:

info@winkworthfarm.com / 01666 823 499



The Next Steps...

If you would like to hold your wedding with us here at Winkworth Farm, the next steps are as follows:

Contact our office to check date availability and place a date on hold (and Holiday Lets if looking to book those).

Contact the registrars or Church to check availability for your ceremony (if required).

Read, sign and return our booking forms and T&Cs. A 25% venue hire deposit is due at the time of booking (or 50% if within a year), with a further 25% instalment due one year prior. The 50% balance is due 8 weeks prior. Extras (ceremony fee, drinks etc.) and Holiday Lets are billed separately.

Get in touch...

info@winkworthfarm.com
01666 823 499



@ winkworthfarm

